

St Martin's House

Le Bordage, St Peter Port, Guernsey



Computer generated image of refurbished reception area

2,499 - 5,374 sq ft of high quality fitted offices



Description

St Martin's House provides 2,499 sq ft and 2,875 sq ft of office accommodation over ground and second floors. Within the building's secure underground car park, each floor has 5 allocated car parking spaces. The spaces are available separately or together.

The offices are undergoing a significant refurbishment and, once complete, will comprise modern high quality fitted accommodation to include open plan office space with boardrooms, meeting rooms, private offices, kitchenette / break out areas and dedicated WCs.

Further fitout and furniture packages could be available subject to terms.

The entrance and common areas are also soon to undergo a comprehensive refurbishment to provide an enhanced contemporary amenity for all the occupiers.

Floor	sq ft	sq m
Ground	2,499	232
Second	2,875	267
Total	5,374	499

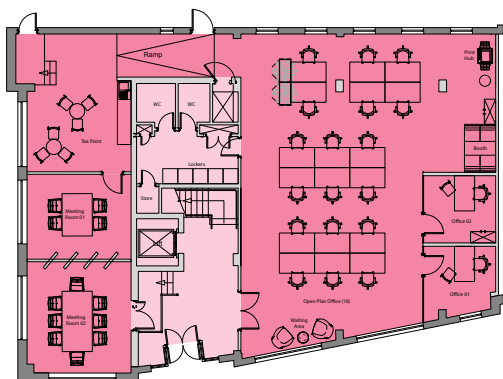

Ground floor - 2,499 sq ft*

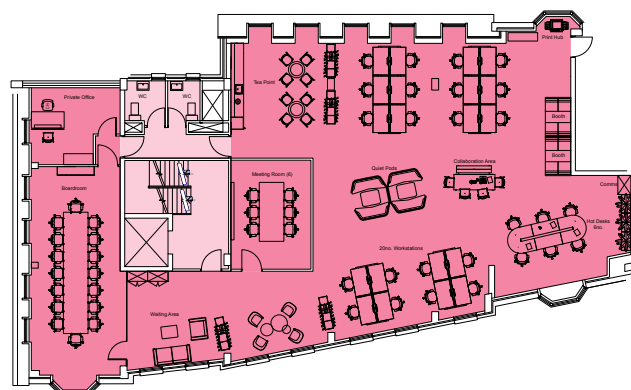

Second floor - 2,875 sq ft*

* Furniture not included but landlord will consider providing subject to wider terms.



Amenities



Raised access flooring



Kitchenette & breakout area



Meeting & boardrooms



5 parking spaces per floor



Demised WCs



Passenger lift



LED lighting



Air conditioning



Suspended ceiling



Carpet flooring



Bicycle parking



Shower facilities



Computer generated image of refurbished reception area



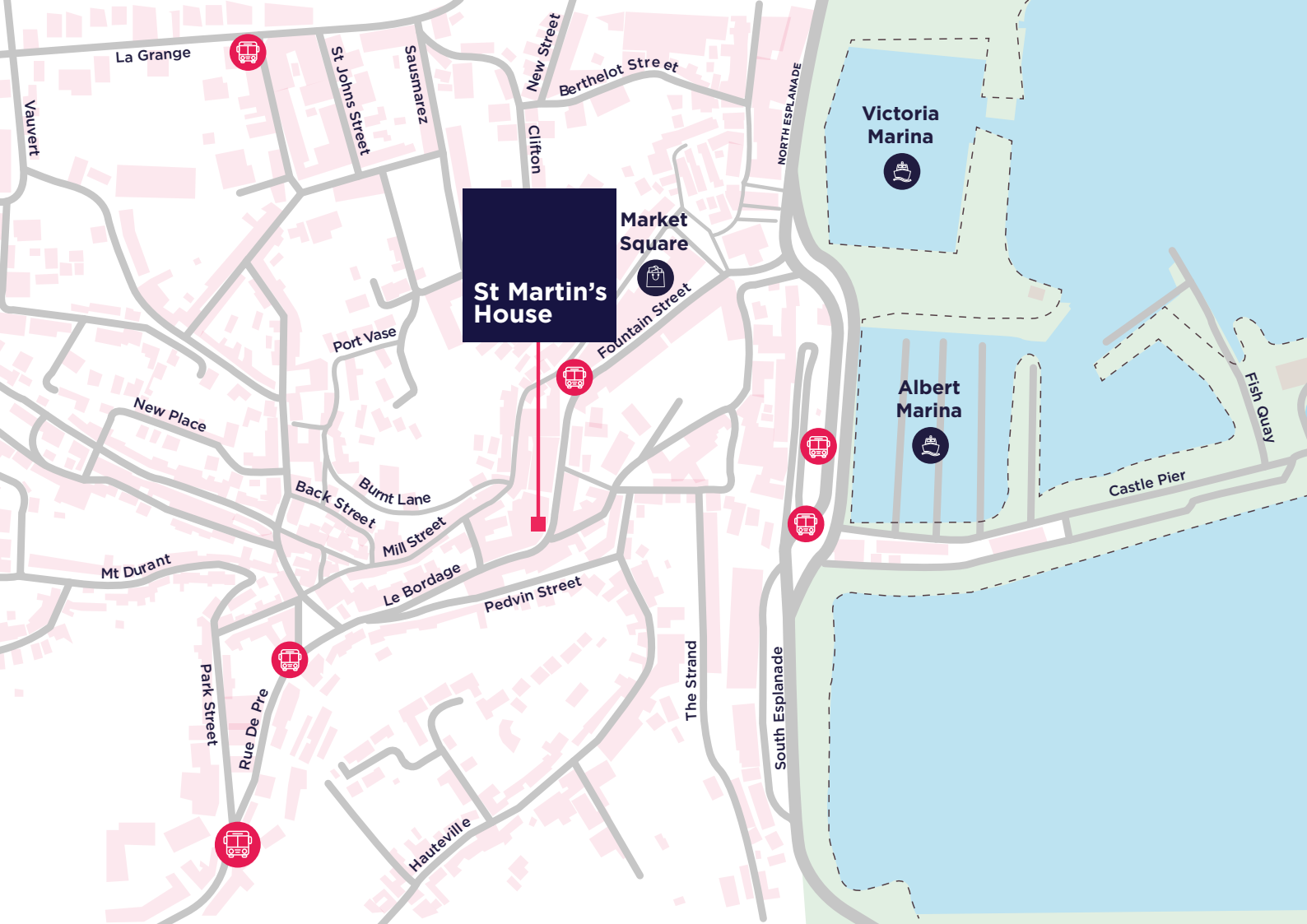

Location

St Martin's House is located on Le Bordage, one of the arterial routes linking St Peter Port with the south and south western parishes.

It forms part of an established office location and sits within walking distance of St Peter Port's High Street and the amenities it has to offer.

Destination

Walk

Market Square	3 mins
High Street	5 mins
Victoria Marina	8 mins
Sunken Gardens	10 mins
Guernsey Yacht Club	13 mins
La Vallette Bathing Pools	15 mins

Our commitment to our customers

Hargreaves, established over 60 years ago, is a family-owned property investment and development business. Our properties are concentrated along the south coast and increasingly across the wider South East. As a long-term investor, we take pride in what we own and in our responsibilities within the communities in which we operate. We have three core principles that we uphold:

- Build long term relationships with our customers and help them achieve their goals by providing high quality real estate solutions to suit their needs
- Deliver a best-in-class property management service from our locally based offices in Rustington
- Execute on our commitment to our environmental and social goals to achieve better solutions for people and the local environment
- For full details please visit: www.hargreaves.co.uk/about-us



01903 777 772

Contact

Wing Lai

01481 740071

07781 412578

wing.lai@watts.property

Joanna Watts

01481 740071

07781 130686

jo.watts@watts.property



Every care is taken in the preparation of these particulars, however, Rock Commercial nor its agents nor the landlord/vendor are responsible for any errors, omissions or misstatements contained within them. They do not constitute an offer or contract and no employee of Rock Commercial has the authority to make or give any representation, or warranty in relation to this property. Prospective purchasers and/or tenants should conduct their own investigation before making any agreement to purchase or lease this property. Measurements are given for guidance purposes only and are approximate. Designed by www.take-shape.co.uk. February 2025.